

## PRODUCT DESCRIPTION

The Model A PS019/PS020/PS025/PS026(Glass Bulb Type)Standard Orifice Standard Upright, Pendent and Recessed Pendent Standard and Quick Response. The Model A Pendent Sprinkler Identification Number (SIN) PS020(quick) PS026(standard) Recessed Pendent. The Model A Upright Sprinkler Identification Number (SIN) PS019(quick) PS025(standard). The design incorporates state-of-the-art, heat responsive, frangible glass bulb design (standard or quick response) for prompt, precise operation. The die cast frame is more streamlined and attractive than traditional sand cast frames. It is cast with a hex-shaped wrench boss to allow easy tightening from many angles, reducing assembly effort. This sprinkler is available in various temperature ratings (see chart on page 2) and finishes to meet many design requirements. The recessed pendent should be utilized with a Model A recessed escutcheon which provides up ¾” of adjustments. All Protector Sprinklers are manufactured using the time proven Belleville seal used exclusively by all major manufactures to ensure long life and safe operation.

### Sprinkler Operation

The operating mechanism is a frangible glass bulb which contains a heat responsive liquid. During a fire, the ambient temperature rises causing the liquid in the bulb to expand.

When the ambient temperature reaches the rated temperature of the sprinkler, the bulb shatters. As a result, the waterway is cleared of all sealing parts and water is discharged towards the deflector. The deflector is designed to distribute the water in a pattern that is most effective in controlling the fire.

### Maximum Coverage

Standard spray coverage is up to: Light Hazard =314 square feet (29.2 sq.m); Ordinary Hazard = 176 square feet(16.6 sq.m)per NFPA 13. see page 4 for distribution patterns.

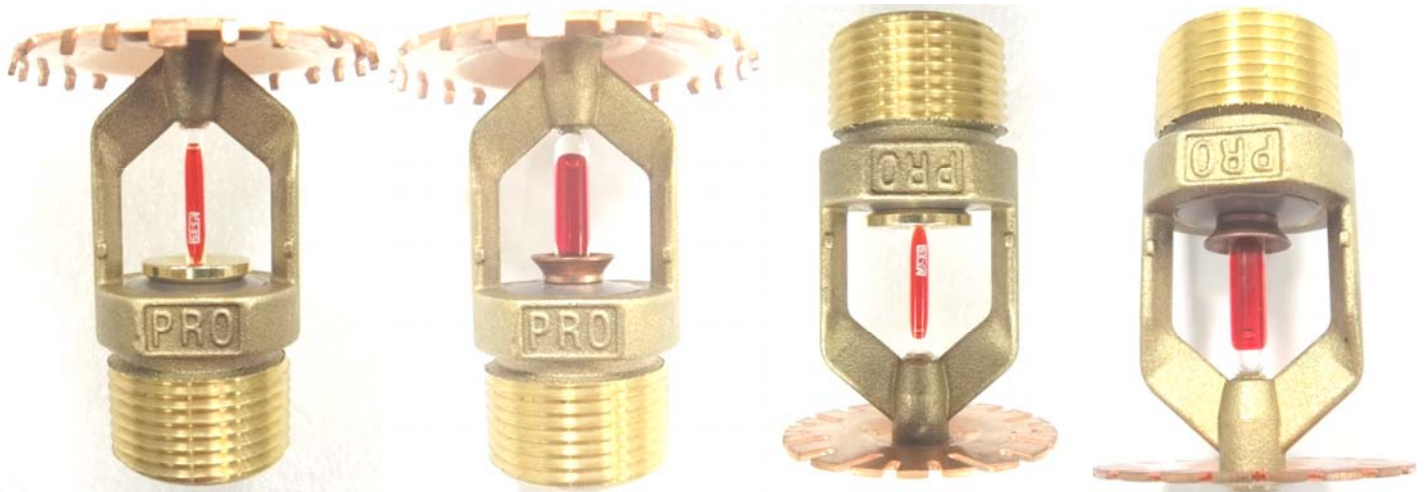

PS019

PS025

PS020

PS026

# TECHNICAL SPECIFICATION

SIN : Quick Response PS019、PS020 (bulb 3mm) , , Standard PS025、PS026 (bulb 5mm)

Style : Upright Sprinkler PS019、PS025, Pendent Sprinkler PS020、PS026

K-Factor : 14.0Imp.(115S.I)

Response Time Index(RTI) : Quick Response 30, Standard 50

Norminal Thread Size : 3/4"NPT(20mm)

Max. Working Pressure : 175PSI(1200kPa)

Factory Hydrostatic Test : 100% @500PSI(3450 kPa)

Min. Operation Pressure : 7 PSI(48 kPa)

## RATINGS

SPRINKLRE TEMPERATURE CLASSIFICATION	NORMINAL SPRINKLER TEMPERATURE RATING	N.F.P.A MAXIMUM AMBIENT (CEILING) TEMP.(ALLOWED)	GLASS BULB COLOR
Ordinary	155°F/68°C	100°F/38°C	Red
Intermediate	175°F/79°C	150°F/65°C	Yellow
Intermediate	200°F/93°C	150°F/65°C	Green

## DIMENSIONS

FRAME AND DEFLECTOR FINISH PENDANT BRASS,CHROME, BAKE PAINTING

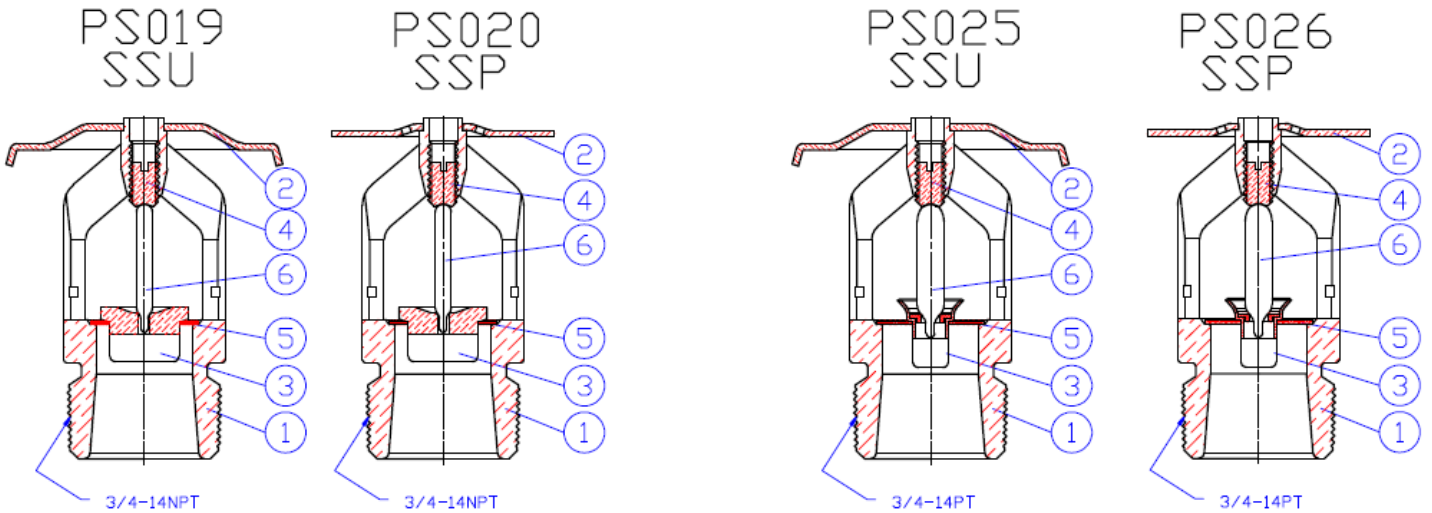

玻璃球 BULB	6	NORBULB N3-68°C-20mm
K14.0 彈片 SEAL	5	BERY. NICKEL SPRING TEFLON TAPE
螺絲 LOAD SCREW	4	ASTM C36000(CNS C3604)
內銅柱 CAP	3	ASTM C36000(CNS C3604)
QR 封板 DEFLECTOR 68°C	2	ASTM C11000(CNS C1100)
K114 本體 FRAME	1	ASTM C37700(CNS C3771)

玻璃球 BULB	6	NORBULB N5-68°C-20mm
K14.0 彈片 SEAL	5	BERY. NICKEL SPRING TEFLON TAPE
螺絲 LOAD SCREW	4	ASTM C36000(CNS C3604)
內銅柱 CAP	3	ASTM C11000(CNS C1100)
QR 封板 DEFLECTOR 68°C	2	ASTM C11000(CNS C1100)
K114 本體 FRAME	1	ASTM C37700(CNS C3771)

**PROTECTOR SPRINKLER**

An  9001certified company

# DISCHARGE CURVE

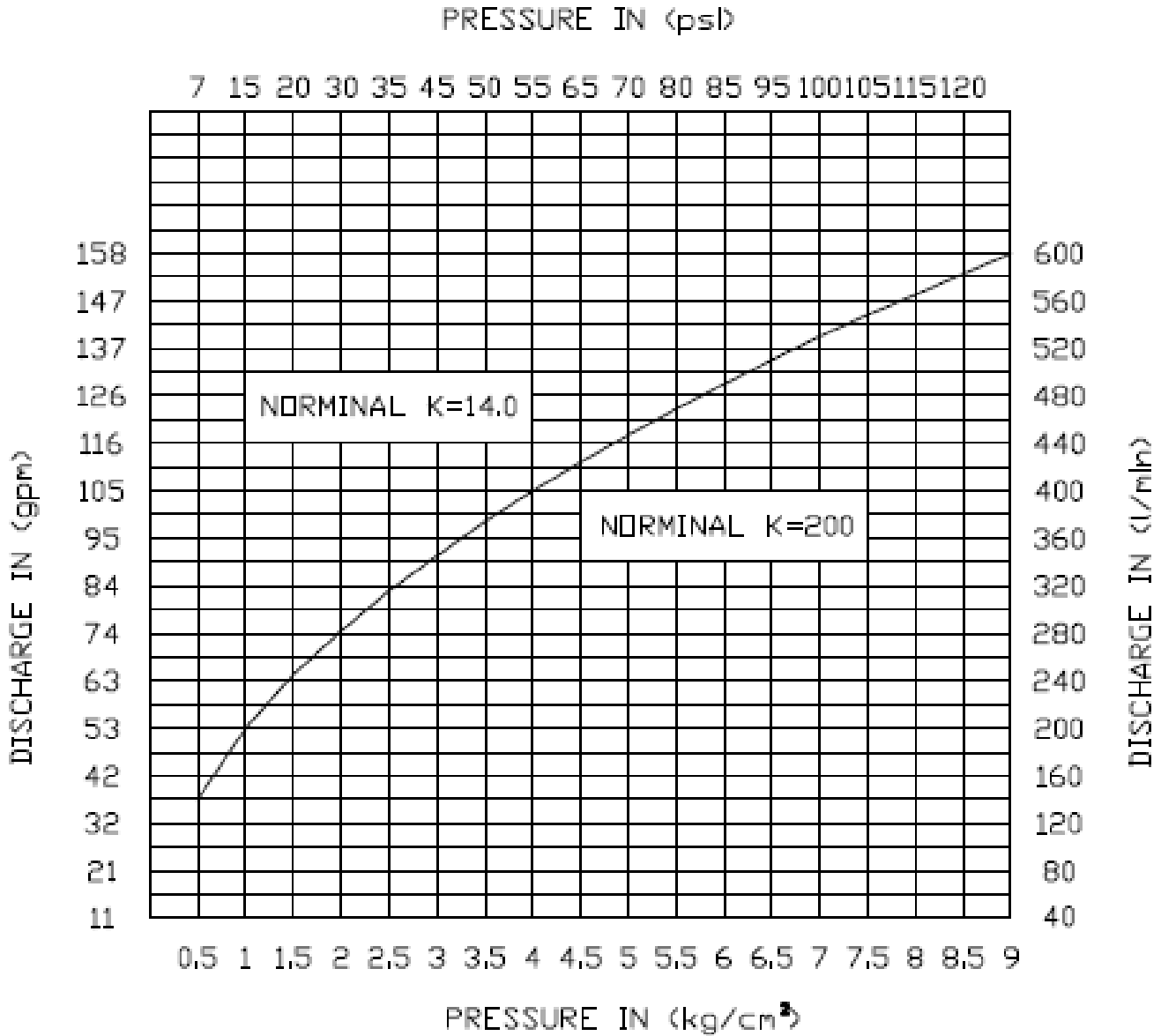

# DISTRIBUTION PATTERNS

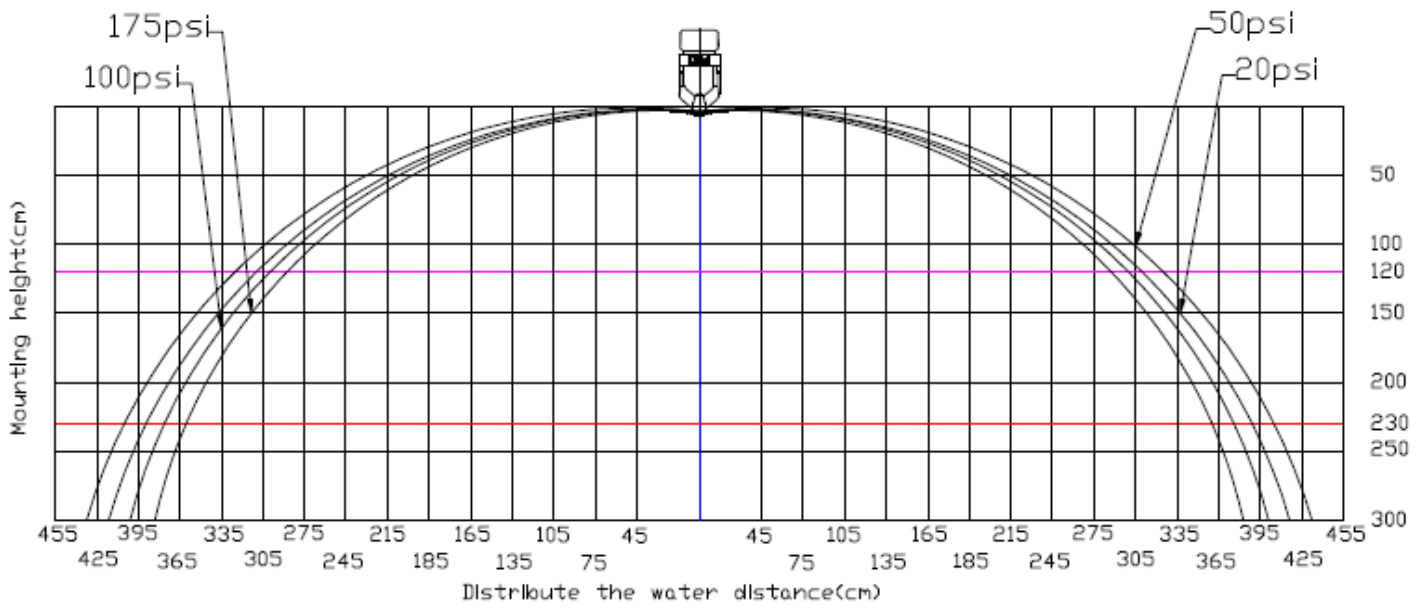

K14.0 PENDENT SPRINKLER  
DISTRIBUTION PATTERNS - TRAJECTORY

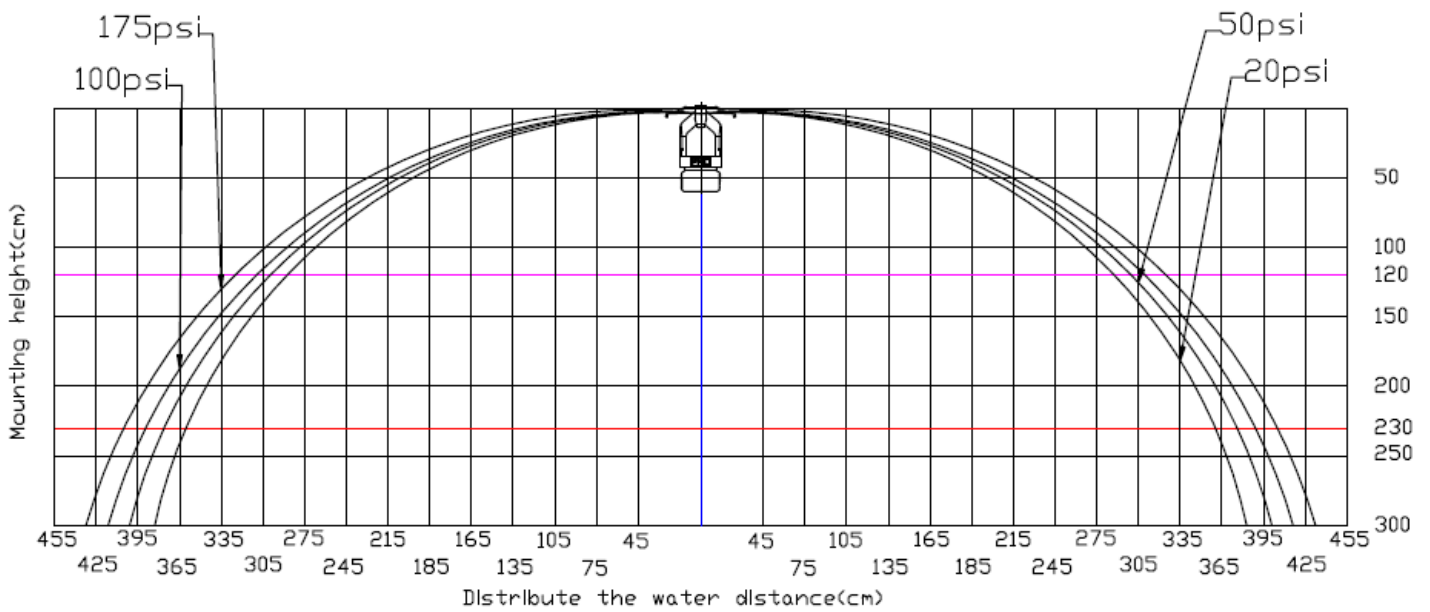

K14.0 UPRIGHT SPRINKLER  
DISTRIBUTION PATTERNS - TRAJECTORY

# DIMENSIONS

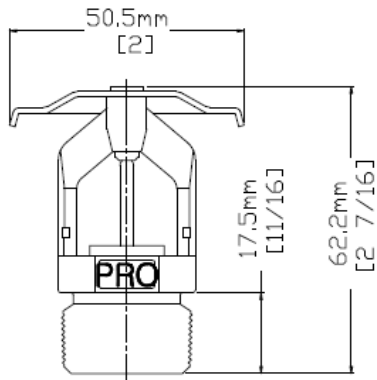

Upright Sprinkler

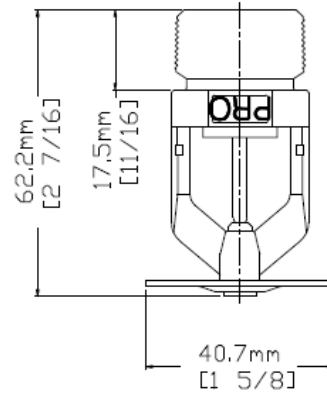

Pendent Sprinkler

## Recessed Pendent Sprinkler

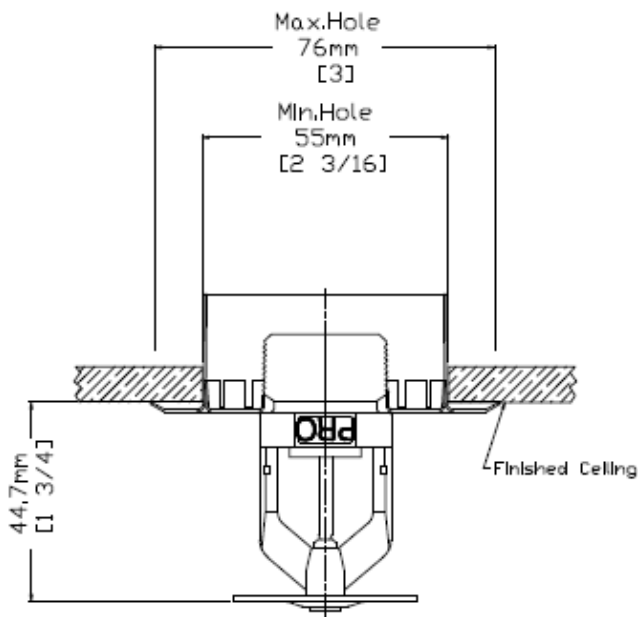

MAXIMUM EXTENSION

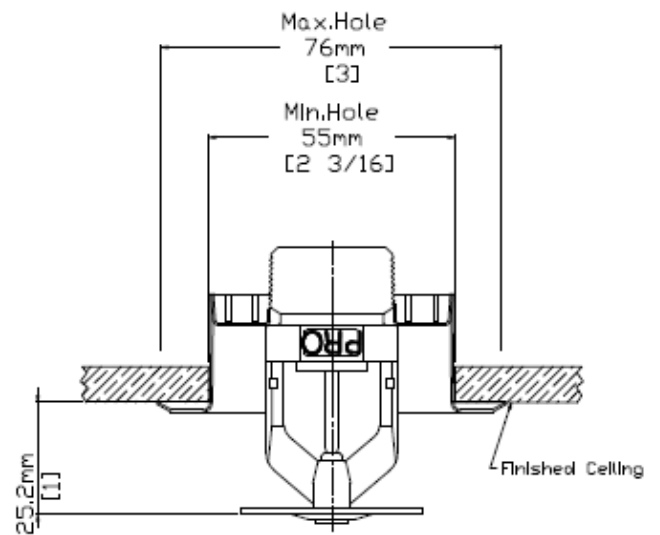

MAXIMUM RECESS

3/4" ADJUSTMENT